

# HSF

NOTES:  
 Rated Current: 1.5AMP  
 Contact Resistance: 20mΩ max  
 Withstand Voltage: 250V AC/DC  
 Insulation Resistance: 1000MΩ min  
 Operation Temperature: -25°C to +85°C

Contact Material: Brass  
 Contact plating: Au Or Sn Over Ni  
 Insulator Material: PA66 UL94V-0

Recommended P.C.B Layout(Top Side)  
 (PCB BOARD TOLERANCE ±0.05)

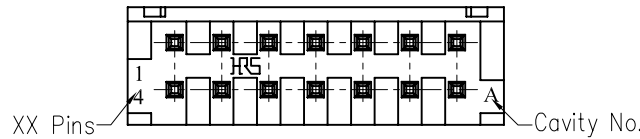
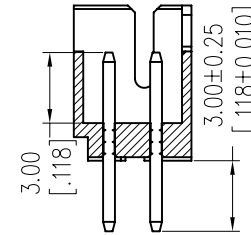
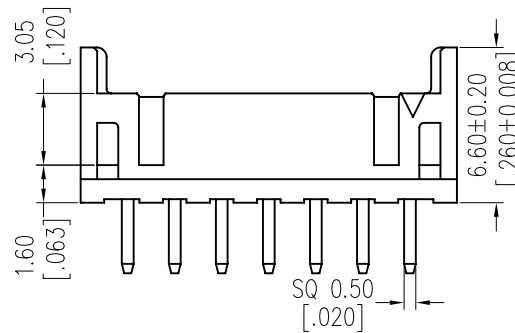
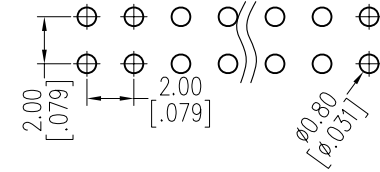
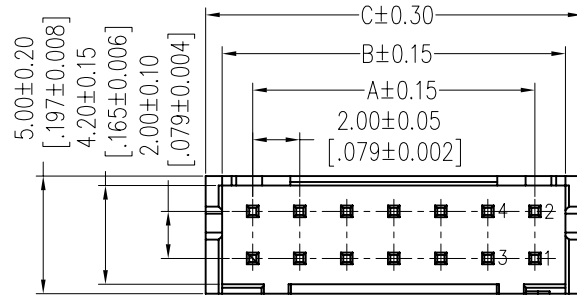

## Ordering Information

WF2002B - WS XX X T 1

No. of pins: 10-28P  
 Contact Plating:  
 S0=Gold Flash/Tin  
 S3=10u"Gold/Tin  
 S4=15u"Gold/Tin  
 S5=30u"Gold/Tin  
 G0=Gold Flash  
 G3=10u"Gold  
 G4=15u"Gold  
 G5=30u"Gold  
 Blank=Tin  
 Color:  
 B=Black  
 W=White  
 E=Beige  
 Packing:  
 T=Tube

## Specification & Ordering Information:

Circuit	Part No.	Dimension		
		A	B	C
10	WF2002B-WS10XT1	8.00	10.60	12.00
12	WF2002B-WS12XT1	10.00	12.60	14.00
14	WF2002B-WS14XT1	12.00	14.60	16.00
16	WF2002B-WS16XT1	14.00	16.60	18.00
18	WF2002B-WS18XT1	16.00	18.60	20.00
20	WF2002B-WS20XT1	18.00	20.60	22.00
22	WF2002B-WS22XT1	20.00	22.60	24.00
24	WF2002B-WS24XT1	22.00	24.60	26.00
26	WF2002B-WS26XT1	24.00	26.60	28.00
28	WF2002B-WS28XT1	26.00	28.60	30.00

REV	DATE	MODIFICATION DESCRIPTION	CHANGE	OPERATION	DRAW	DATE	SCALE	FIT	PART NO.
A0	2012/08/25	NEW		X.X ±0.40	JYHuang	2012/08/25	UNIT mm/inch		SEE TAB
				X.XX ±0.25	CHECK	DATE	SIZE A4		TITLE: PHD2.0 WAFER 180°
				X.XXX ±0.15	APPROVE	DATE	SHEET 1/1		Customer NO.
				Angle ± 3°			PROJ.		
				DIM TOL					